

MojaveRd10 El Dorado Cañon Road

El Dorado Pg 1



GROTTO HILLS ROAD

Grotto
(Guirado)
Hills

Mi 96.1/43.7 INTERSECTION: 35.139792,-115.217798
Junction Mojave Road with EL DORADO CAÑON ROAD.
Historic route north through Searchlight, Nevada and
beyond to gold mines in El Dorado Cañon, circa 1860s.
This route also connected travelers to the Salt Lake Trail.
The El Dorado trail from here to the northeast is faint in
some areas, but still exists in a nearly straight line through
Lanfair Valley, merging with the East Lanfair Valley Trail in
11.3 miles at 35.228664,-115.060938. This intersection
can be found on map MojaveRd7 East Lanfair Tr North
Page 8.

Mi 95.9/43.9
35.139599,-115.220747
MOJAVE ROAD INTERSECTION
WITH GROTTO (GUIRADO)
HILLS ROAD.

EL DORADO CAÑON ROAD

Elev 4280

Mojave Road

Remains of trail
obliterated

WASH

WASH

Elev 4150

RANCHO AVE

1 MILE

UNKNOWN
RANCH

LIGHTLY TRAVELED ROAD

Elev 4130

EL DORADO CAÑON ROAD

TO
PAGE 2

Ivanpah-Lanfair Road

Mi 97.8/42
35.13866,-115.186983
MOJAVE ROAD INTERSECTION
WITH IVANPAH-LANFAIR
ROAD.

Elev 4100



El Dorado Pg 1

GO TO MAP
MojaveRd2 EAST
Page 19



RESIDENCES

JUNCTION
35.185582,-115.137578

Elev 3980

JUNCTION/CONVERGENCE
OF ROADS.
35.180578,-115.146840

EL DORADO CAÑON ROAD

NEW CENTURY ROAD

35.176948,-115.155162
Junction with road.

Road to northwest is difficult to see from the east/west roads. It was a prominent road on early maps. It follows on the east side of a small wash for about 600 feet and then becomes visible at this point. Junction with New York Mountain Road will be about 2.8 miles northwest.

TO PAGE 1

TO PAGE 2

Elev 4045

JUNCTION WITH WASH
35.176304,-115.153605

JUNCTION WITH IVANPAH
-LANFAIR ROAD
35.171418,-115.195669

JUNCTION
35.171550,-115.161491

EL DORADO CAÑON ROAD

UNKNOWN RANCH

JUNCTION
35.160676,-115.181036

Elev 4130

RANCHO AVE



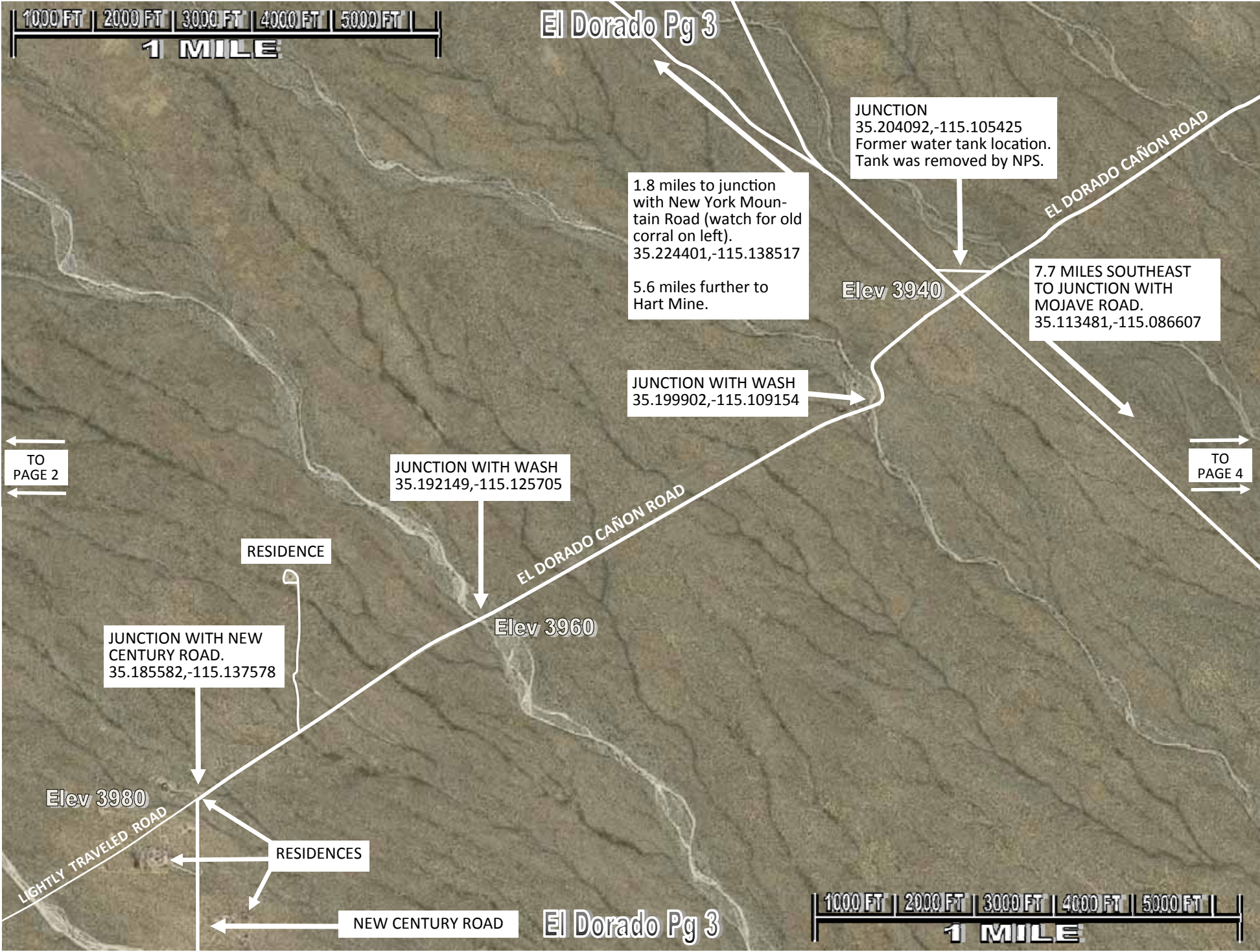

El Dorado Pg 3

1000 FT | 2000 FT | 3000 FT | 4000 FT | 5000 FT |
1 MILE

JUNCTION
35.204092,-115.105425
Former water tank location.
Tank was removed by NPS.

1.8 miles to junction
with New York Mountain
Road (watch for old
corral on left).
35.224401,-115.138517

5.6 miles further to
Hart Mine.

7.7 MILES SOUTHEAST
TO JUNCTION WITH
MOJAVE ROAD.
35.113481,-115.086607

Elev 3940

JUNCTION WITH WASH
35.199902,-115.109154

TO
PAGE 2

JUNCTION WITH WASH
35.192149,-115.125705

TO
PAGE 4

RESIDENCE

EL DORADO CAÑON ROAD

Elev 3960

JUNCTION WITH NEW
CENTURY ROAD.
35.185582,-115.137578

Elev 3980

RESIDENCES

LIGHTLY TRAVELED ROAD

NEW CENTURY ROAD

El Dorado Pg 3

1000 FT | 2000 FT | 3000 FT | 4000 FT | 5000 FT |
1 MILE



El Dorado Pg 4

GO TO MAP
MojaveRd7 EAST
LANFAIR TR
NORTH Page 8

EL DORADO CAÑON ROAD

Junction with EAST LANFAIR VALLEY TRAIL.
El Dorado Cañon Road merges with the East Lanfair Valley Trail beginning here and they run together to the north. The El Dorado Cañon Road from here to the southwest runs in nearly a straight line through Lanfair Valley, although it's a bit faint in some areas. It ends at the Mojave Road in 11.3 miles at GPS 35.139792,-115.217798. This intersection can be found on map MojaveRd2East Page 27.

INTERSECTION
35.228664,-115.060938

Elev 3890

East Lanfair Valley Trail NORTH

TO
PAGE 3

EARTHEN DAM
35.211584,-115.038195

1.8 miles to junction
with New York Mountain
Road (watch for old
corral on left).
35.224401,-115.138517

5.6 miles further to
Hart Mine.

JUNCTION
35.204092,-115.105425
Former water tank loca-
tion. Removed by NPS.

MINE
SHAFT

Elev 3750

MOJAVE ROAD
8.3 MILES

7.7 MILES SOUTH TO
JUNCTION WITH MOJAVE
ROAD.
35.113481,-115.086607

Elev 3940

El Dorado Pg 4

GO TO MAP
MojaveRd7 EAST
LANFAIR TR
NORTH Page 8

