

Relay Locations, 1993 240

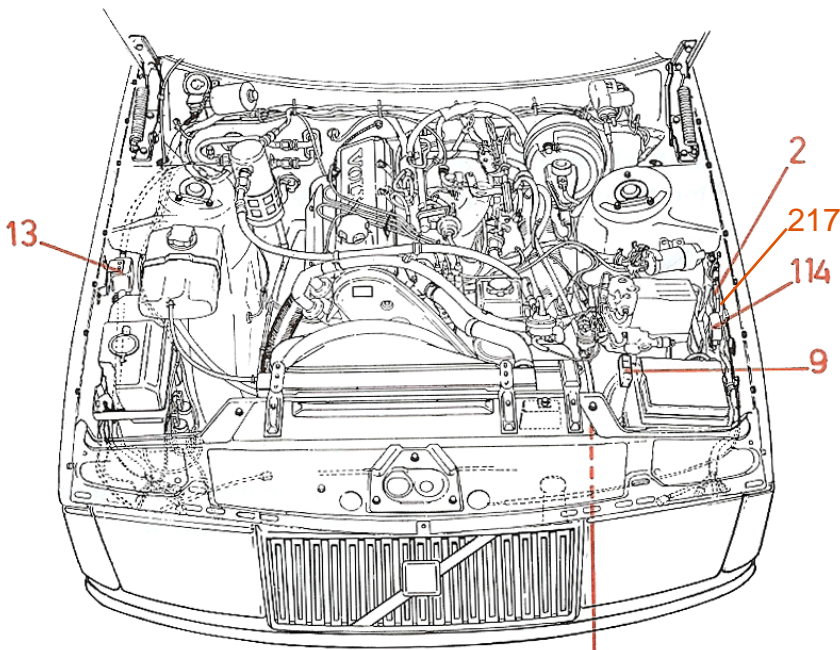

- 2 Power junction box (12v from battery)
- 9 Fuse, B+
- 13 Headlight relay (stepped high/low beam)
- 114 Engine cooling fan relay
- 217 Main relay, LH fuel injection
- 237 Relay, ignition lock regulated B+ supply, towing hook contact

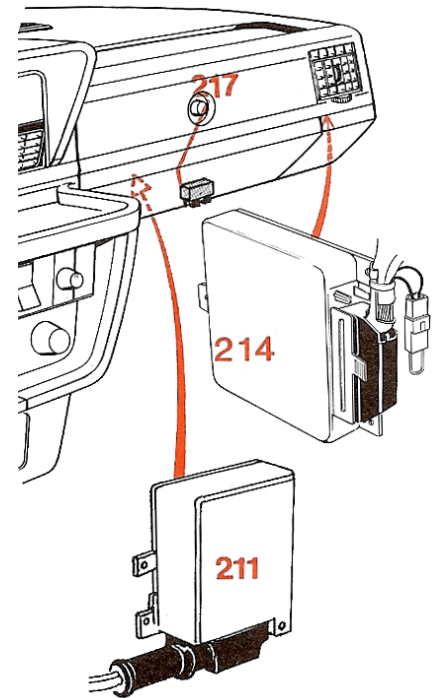
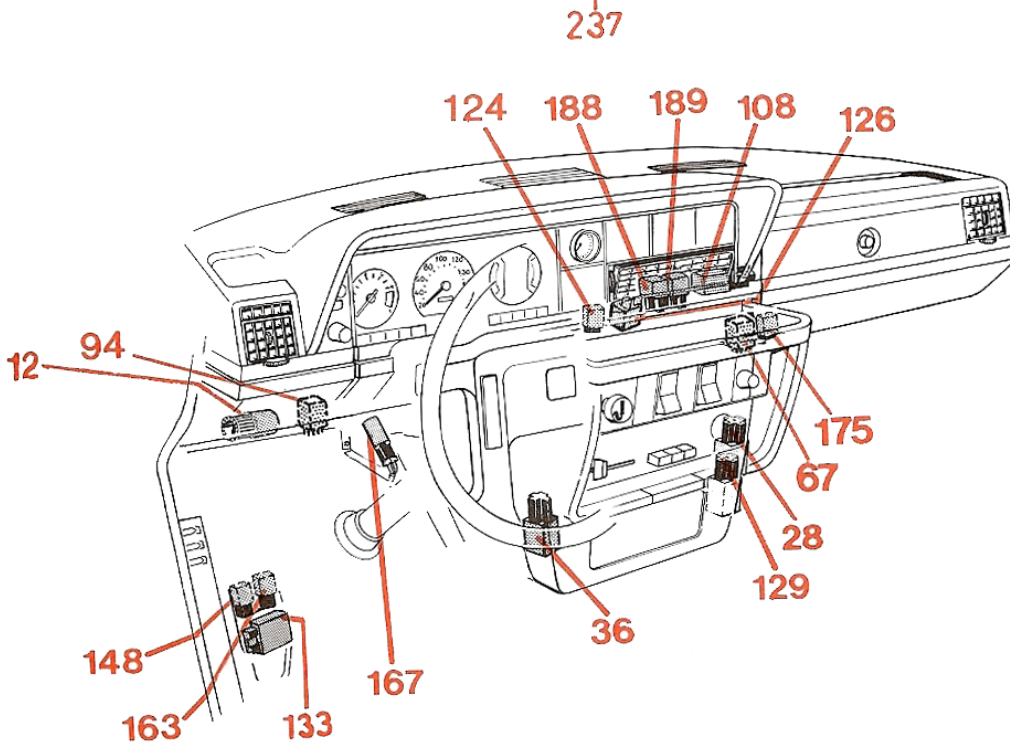

- | | | | |
|-----|----------------------------------|-----|---------------------------------------|
| 12 | Bulb failure warning relay | 163 | Tailgate wiper interval relay |
| 28 | Turn signal flash relay | 164 | Glowplug current relay (diesel) |
| 36 | Park shifter lock relay | 167 | Relay, delayed cabin light |
| 67 | Timed relay, heated door mirrors | 175 | Times relay, heated rear window |
| 94 | Fasten seat belt light (USA) | 188 | Central lock system relay (unlocking) |
| 108 | Transmission overdrive relay | 189 | Central lock system relay (locking) |
| 124 | Main headlight relay | 196 | ABS module |
| 126 | Power window relay | 211 | Ignition control unit, EZ-116 K |
| 129 | Air conditioning relay | 214 | ECU, LH fuel injection |
| 133 | Headlight dim/dip relay (GB) | | |
| 148 | Windshield wiper interval relay | | |